

A : 3房 477'		
樓層	訂價	折實價30%
3	\$15,937,200 @\$33,411	\$11,156,040 @\$23,388
5	\$16,141,700 @\$33,840	\$11,299,190 @\$23,688
6	\$16,339,400 @\$34,255	\$11,437,580 @\$23,978
15	\$17,238,800 @\$36,140	\$12,067,160 @\$25,298
17	\$17,545,400 @\$36,783	\$12,281,780 @\$25,748
21	\$18,104,200 @\$37,954	\$12,672,940 @\$26,568
27	\$19,194,500 @\$40,240	\$13,436,150 @\$28,168

B : 2房 361'		
樓層	訂價	折實價30%
3	\$11,411,800 @\$31,612	\$7,988,260 @\$22,128
5	\$11,530,400 @\$31,940	\$8,071,280 @\$22,358
6	\$11,649,000 @\$32,269	\$8,154,300 @\$22,588
7	\$11,741,800 @\$32,526	\$8,219,260 @\$22,768
8	\$11,834,700 @\$32,783	\$8,284,290 @\$22,948
9	\$11,917,100 @\$33,011	\$8,341,970 @\$23,108
10	\$11,999,700 @\$33,240	\$8,399,790 @\$23,268
11	\$12,087,400 @\$33,483	\$8,461,180 @\$23,438
12	\$12,169,800 @\$33,711	\$8,518,860 @\$23,598
15	\$12,257,500 @\$33,954	\$8,580,250 @\$23,768
17	\$12,432,800 @\$34,440	\$8,702,960 @\$24,108
21	\$12,773,200 @\$35,383	\$8,941,240 @\$24,768
27	\$13,361,100 @\$37,011	\$9,352,770 @\$25,908

C : 2房 361'		
樓層	訂價	折實價30%
3	\$11,350,000 @\$31,440	\$7,945,000 @\$22,008
5	\$11,468,500 @\$31,769	\$8,027,950 @\$22,238
6	\$11,576,800 @\$32,069	\$8,103,760 @\$22,448
17	\$12,634,000 @\$34,997	\$8,843,800 @\$24,498
18	\$12,783,500 @\$35,411	\$8,948,450 @\$24,788
19	\$12,938,200 @\$35,840	\$9,056,740 @\$25,088
20	\$13,098,100 @\$36,283	\$9,168,670 @\$25,398
21	\$13,252,800 @\$36,711	\$9,276,960 @\$25,698
22	\$13,407,500 @\$37,140	\$9,385,250 @\$25,998
27	\$14,155,400 @\$39,212	\$9,908,780 @\$27,448

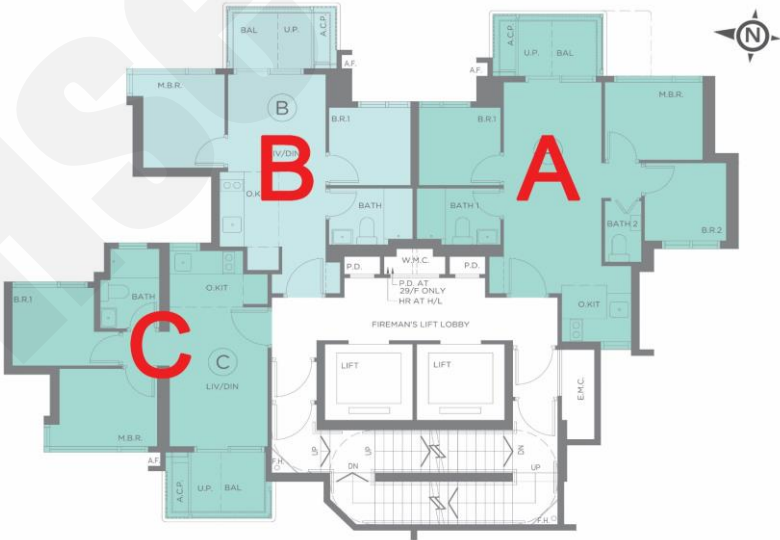

紅色為最高售價、最高平均呎價；藍色為最低售價、最低平均呎價